

ROW SPACING

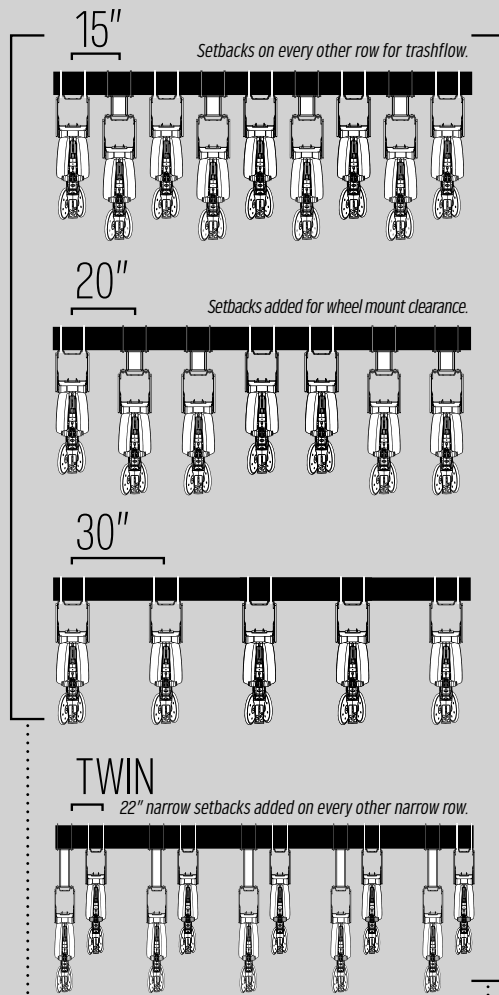

LASERPRO 1
Can be configured individually on any row spacing 14" & wider. Mini-hoppers or seed boxes.

LASERPRO 1N
Can be configured individually on any row spacing narrow as 8", ideal for twin row.

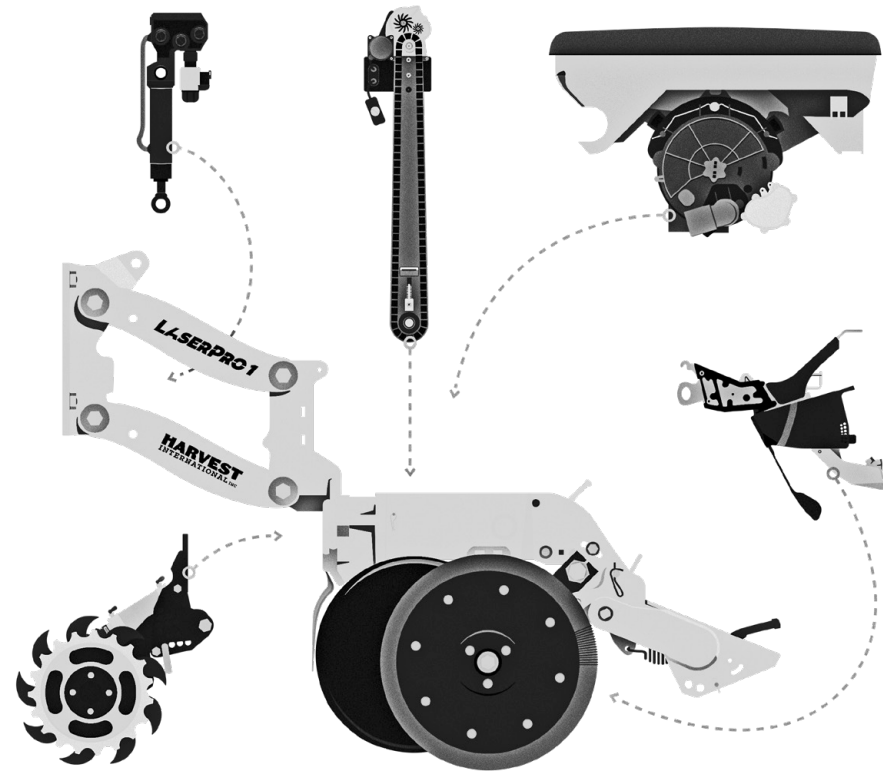

LASERPRO1™ ROW UNITS DO NOT INCLUDE, BUT OFFER COMPATIBILITY* WITH MOST AGLEADER & PRECISION PLANTING PRODUCTS ALONG WITH MOST AFTERMARKET FERTILIZER APPLICATORS, CLOSING WHEELS, ROW CLEANERS, ETC.

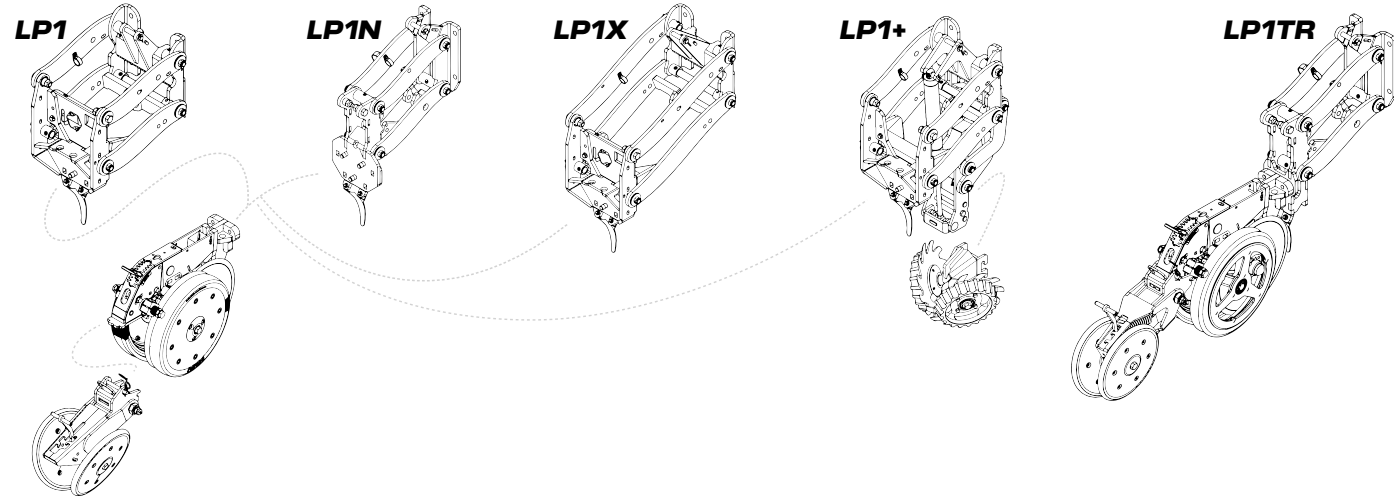

*NOTE: NOT ALL PRODUCTS WILL WORK TOGETHER ON ALL MODELS. NOT ALL AFTERMARKET ATTACHMENTS ARE DESIGNED WITH FULL LP1 & LP1N COMPATIBILITY. NO DIRECT AFFILIATION CLAIMED WITH ANY 3RD PARTY COMPANIES.

H HARVEST INTERNATIONAL INC

401 W 20TH STREET • STORM LAKE, IA 50588
TEL: 712.213.5100 • TOLL: 888.218.5373 • 712.213.5109
WWW.HARVEST-INTERNATIONAL.COM

MADE IN THE USA



MANUFACTURER RESERVES THE RIGHT TO MAKE CHANGES AT ANY TIME, WITHOUT NOTICE, TO PRICES, SPECIFICATIONS, & MODELS. ©2022 HARVEST INTERNATIONAL, INC. PRINTED IN THE USA. (07-22)

H HARVEST INTERNATIONAL INC
A FRIESEN COMPANY

INTRODUCING THE LASERPRO 1: A NEW GENERATION OF ROW UNIT.
LASER CUT, HIGH TENSILE STEEL OFFERS A MAXIMUM DURABILITY ROW UNIT FOR PRECISION & HIGH SPEED PLANTING. WHEN IT COMES TO DURABILITY, CONSISTENCY, & SERVICEABILITY, THE LASERPRO1 IS THE GROUNDBREAKING CONTENDER

LASERPRO 1
AVAILABLE IN STANDARD, NARROW, & TWIN ROW WIDTHS
PATENTED & PATENT PENDING

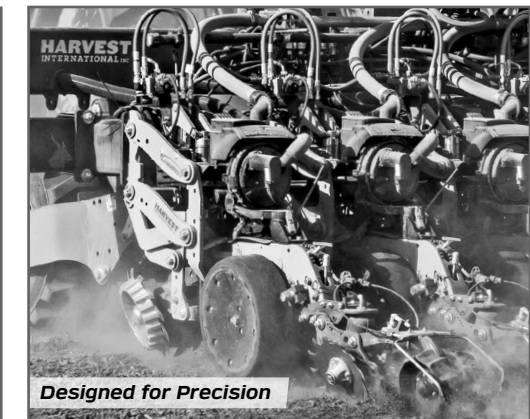
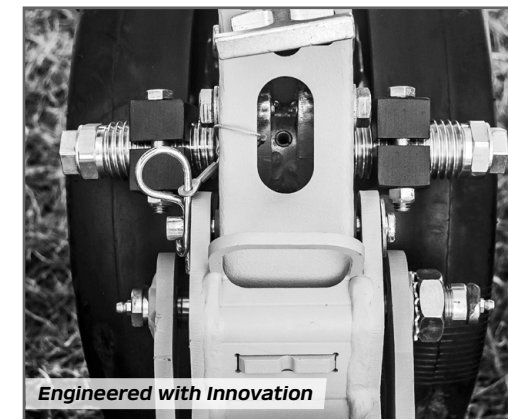

AMERICAN MANUFACTURED

H LASERPRO1

PATENTED & PATENT PENDING

YOUR NEXT HARVEST STARTS HERE, WITH ROW UNITS BUILT TO CONQUER
DESIGNED TO INTEGRATE WITH THE LATEST PRECISION AG SEED METERS & PLANTING TECHNOLOGY

FEATURES

- 1 **TAPERED ULTRADUTY BUSHING ADJUSTMENT**
Dry-lubricated polymer; adjusts in seconds
- 2 **LASER CUT HIGH-TENSILE STEEL**
Unparalleled consistency & durability
- 3 **ROBUST PARALLEL LINK ARM ASSEMBLY**
Reinforced by 1" high yield pivot shaft
- 4 **BUILT-IN DOWNPRESSURE BRACKETS**
DeltaForce & AgLeader down pressure support
- 5 **INTEGRATED GAUGE WHEEL CAMBER ADJUSTMENT**
Quickly adjust wheel angle to remain true to discs
- 6 **LATERAL GAUGE WHEEL ALIGNMENT**
- 7 **QUICKRELEASE™ CLOSING WHEEL MOUNT**
Remove or exchange closing wheels quickly
- 8 **LATERAL CLOSING WHEEL ALIGNMENT**
- 9 **REINFORCED CLOSING TAIL**
Improved for high speed & rough terrain
- 10 **4.5" OR 3" STANDARD CLOSED GAUGE WHEELS**
2.5"/3"/4.5" MudSmith upgrades available
- 11 **STANDARD EXAPTA VALION SEED TUBE PROTECTOR**
- 12 **STANDARD 15" 3.5MM DISC OPENERS**
Angled at 12.5° for improved performance
- 13 **MINI-HOPPER & SEED BOX SUPPORT OPTIONS**
- 14 **VARIOUS VAPPLY SUPPORT OPTIONS AVAILABLE**

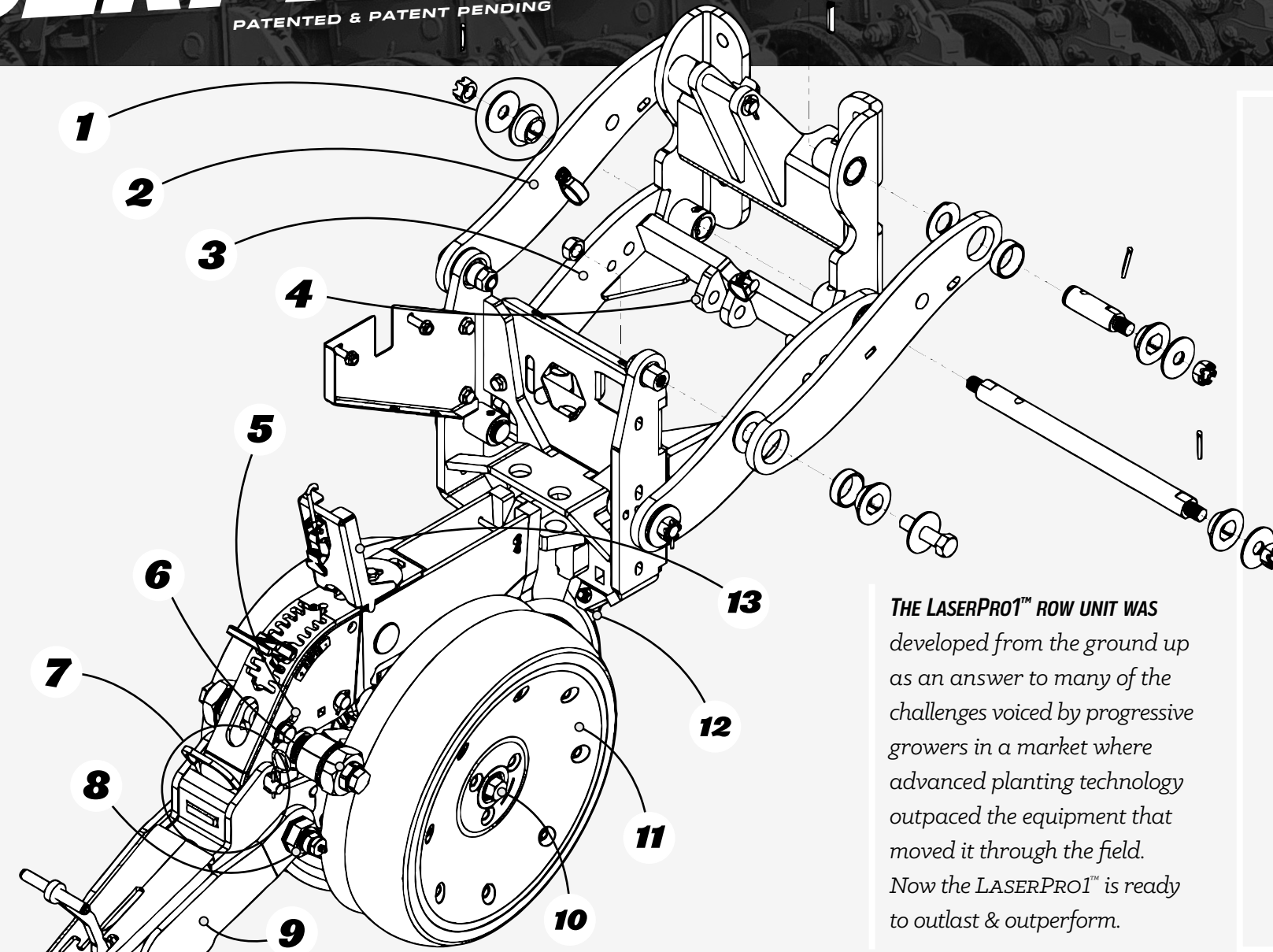

THE LASERPRO1™ ROW UNIT WAS developed from the ground up as an answer to many of the challenges voiced by progressive growers in a market where advanced planting technology outpaced the equipment that moved it through the field. Now the LASERPRO1™ is ready to outlast & outperform.

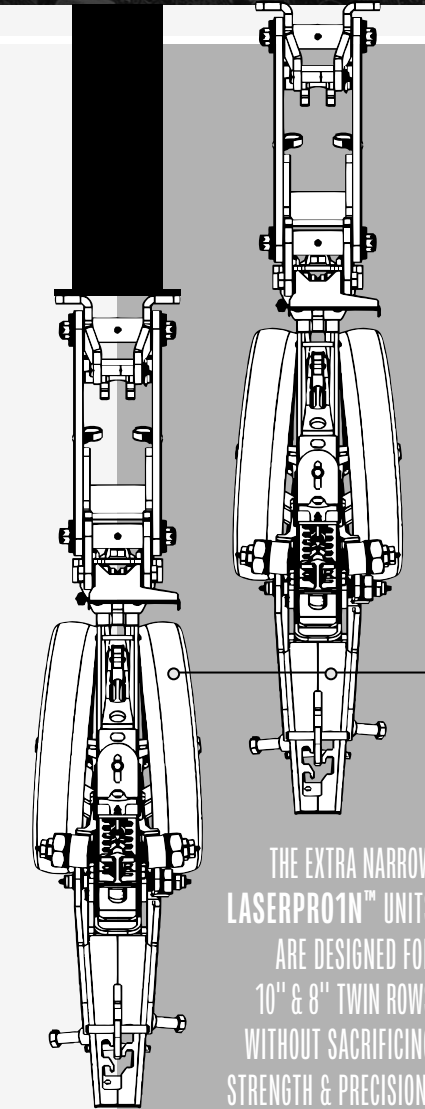

THE EXTRA NARROW LASERPRO1N™ UNITS ARE DESIGNED FOR 10" & 8" TWIN ROWS WITHOUT SACRIFICING STRENGTH & PRECISION.



Narrow LaserPro1N for more room to work
Ideal for narrow row spacings



GREASELESS GAUGE WHEEL ARMS + SIMPLE LATERAL ADJUST
Camber adjustment to keep openers true to gauge wheels



QUICKRELEASE™ CLOSING WHEEL MOUNT
Fast service or closing wheel swap. Pictured with H-I FurrowSpike

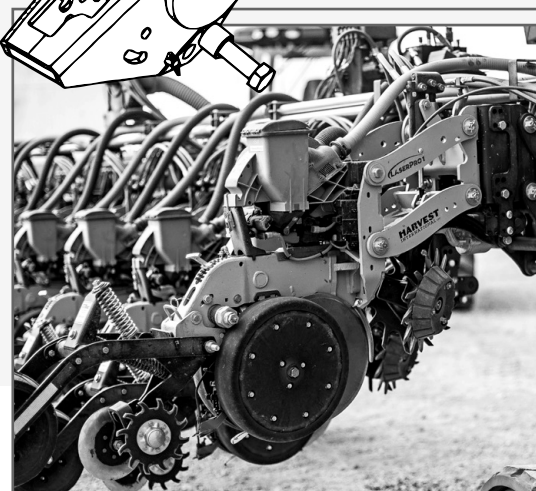

LASERPRO1 facilitates a wide range of aftermarket attachments
Compatible with most aftermarket closing wheels & row cleaners



10" row spacing LASERPRO1TR
Also compatible on 30" & 20" Twin Row

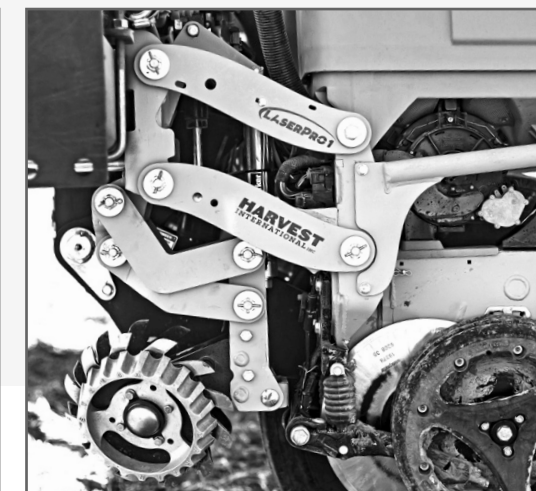

LASERPRO1 + integrated LASERSWEEP™ row cleaner
Integrated X-plate mount with no in-field row unit interference



EXTREME HEAVY DUTY PARALLEL LINK ARMS
Tapered oil-infused poly bushings & solid steel anti-twist shaft.